

ECONO-VUE™

ECONOMICAL PHOTOELECTRIC SENSORS



AC/DC MODELS

Smallest M18 in the industry

Tamperproof models ensure no unauthorized sensitivity adjustment.

Quick disconnect Micro AC (1/2")



55 mm

Actual Size

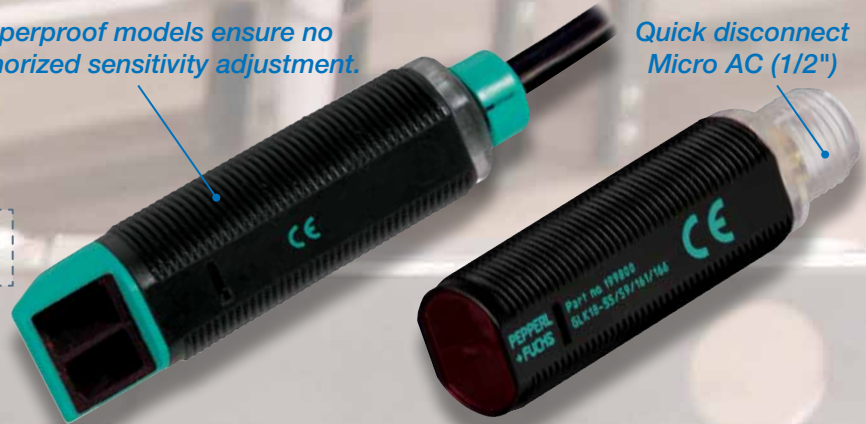

HOUSING STYLES

Available in straight and right-angled configurations with industry-standard M18 housings for virtually any application

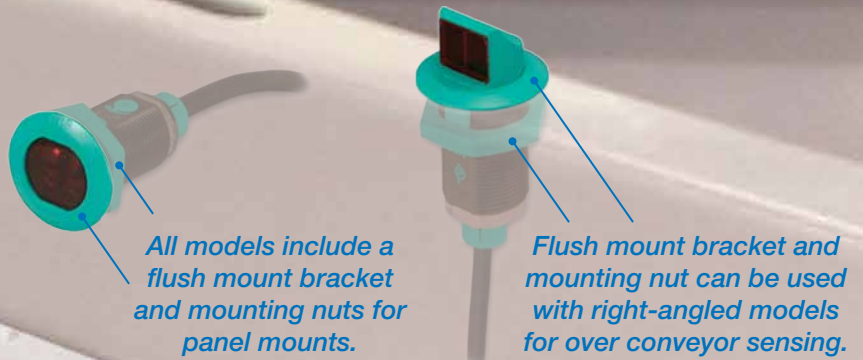

VERSATILE MOUNTING

A variety of mounting accessories enable Econo-Vue sensors to be positioned precisely where you need them.

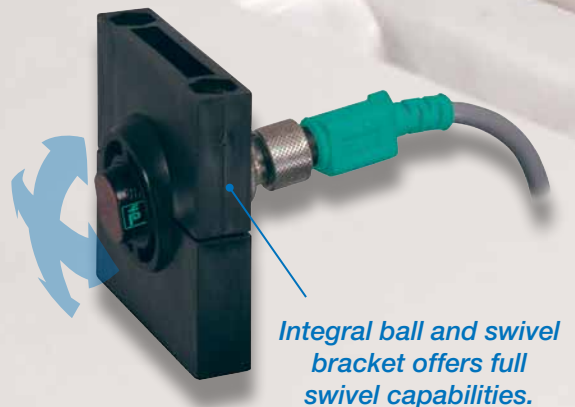
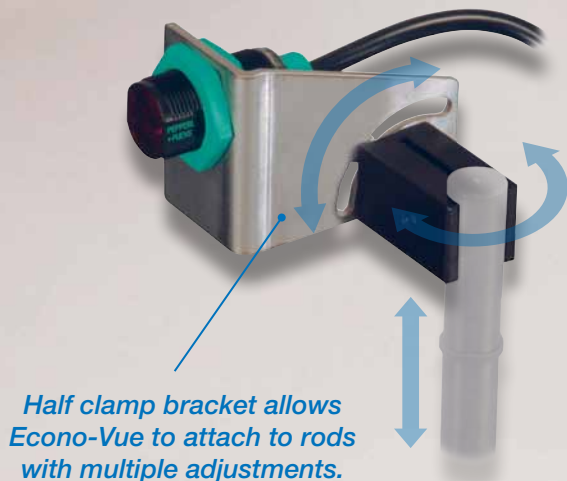

LOW COST, HIGH PERFORMANCE

AN INVALUABLE TOOL FOR A VARIETY OF MARKETS AND APPLICATIONS

DC MODELS

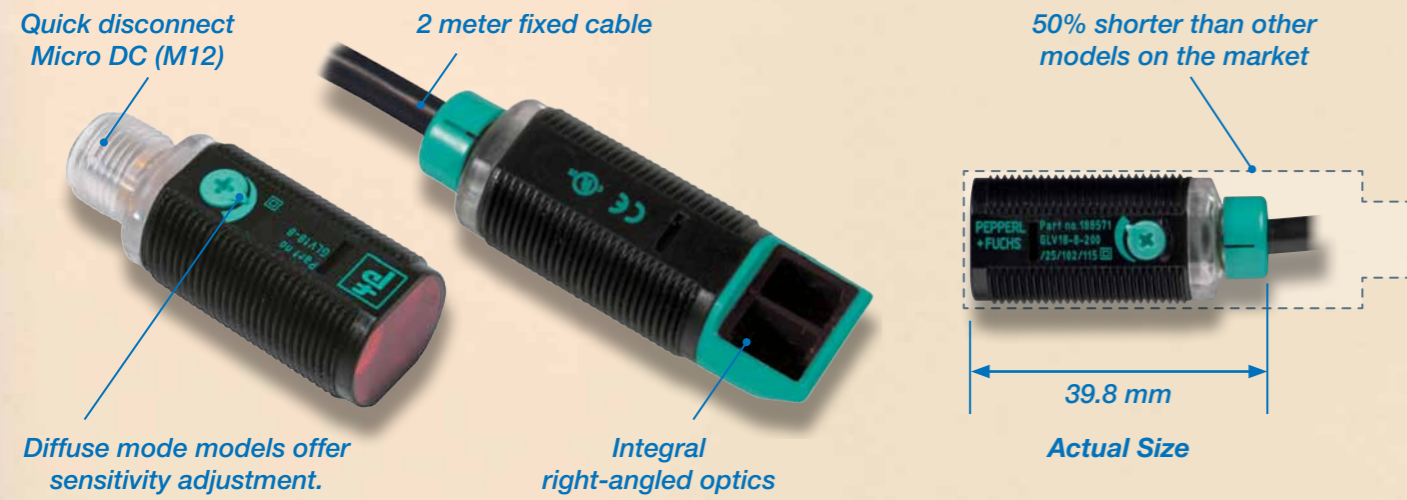

COMMON FEATURES

Econo-Vue™

COMPACT FOOTPRINT

A compact housing with all of the powerful features found in larger sensors

LOWEST POWER CONSUMPTION

Uses up to 50% less power than many other models on the market

HIGHLY VISIBLE LEDs

Dual position green LEDs for power status

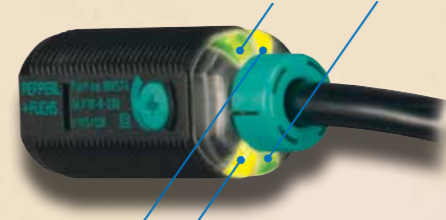

Yellow LEDs indicate when light is received and flash to indicate marginal excess gain.

SENSING MODES

A comprehensive and powerful product line offering five sensing modes and a variety of sensing ranges in straight and right-angled housings

DIFFUSE — Right angle: 200 mm (7.87 in)

DIFFUSE — Straight: 200 mm (7.87 in)

LONG-RANGE DIFFUSE — Right angle: 400 mm (15.75 in)

LONG-RANGE DIFFUSE — Straight: 450 mm (17.72 in)

POLARIZED RETRO-REFLECTIVE — Right angle: 3.5 m (11.5 ft)

POLARIZED RETRO-REFLECTIVE — Straight: 4 m (13.1 ft)

RETRO-REFLECTIVE — Right angle: 5.5 m (18 ft)

RETRO-REFLECTIVE — Straight: 6.5 m (21.3 ft)

THRU-BEAM — Right angle: 12 m (39.4 ft)

THRU-BEAM — Straight: 20 m (65.6 ft)

5 Sensing Modes
Over 100 Models

| Lens Orientation | Diffuse Mode | | Long-Range Diffuse Mode | | Polarized Retro-Reflective Mode | | Retro-Reflective Mode | | Thru-Beam Mode | | | | | | | | | |
|-------------------------------------|-------------------------------------|-------------------------------------|--------------------------|--------------------------|--|--|--|--|------------------------|----------------------|------------------------|-------------------|------------------------|--|------------------------|--|------------------------|--|
| | Straight | Right Angle | Straight | Right Angle | Straight | Right Angle | Straight | Right Angle | Straight | Right Angle | | | | | | | | |
| Sensing Range | 50-200 mm | 50-200 mm | 50-450 mm | 50-400 mm | 0-4 m (50 mm minimum reflector distance) | 0-3.5 m (50 mm minimum reflector distance) | 0-6.5 m (50 mm minimum reflector distance) | 0-5.5 m (50 mm minimum reflector distance) | 0-20 m | 0-12 m | | | | | | | | |
| DC Supply Voltage | | | | | | | | | | | | | | | | | | |
| 2-meter cable, PVC covered, #24 AWG | NPN Light On | GLV18-8-200/25/102/115 | GLV18-8-200-S/25/102/115 | GLV18-8-450/25/102/115 | GLV18-8-400-S/25/102/115 | GLV18-55/25/102/115 | GLV18-55-S/25/102/115 | GLV18-6/25/102/115 | GLV18-6-S/25/102/115 | GV18/25/102/115 | GV18-S/25/102/115 | | | | | | | |
| | NPN Dark On | GLV18-8-200/59/102/115 | GLV18-8-200-S/59/102/115 | GLV18-8-450/59/102/115 | GLV18-8-400-S/59/102/115 | GLV18-55/59/102/115 | GLV18-55-S/59/102/115 | GLV18-6/59/102/115 | GLV18-6-S/59/102/115 | GV18/59/102/115 | GV18-S/59/102/115 | | | | | | | |
| | PNP Light On/Dark On | GLV18-8-200/115/120 | GLV18-8-200-S/115/120 | GLV18-8-450/115/120 | GLV18-8-400-S/115/120 | GLV18-55/115/120 | GLV18-55-S/115/120 | GLV18-6/115/120 | GLV18-6-S/115/120 | GV18/115/120 | GV18-S/115/120 | | | | | | | |
| | Thru-Beam Transmitter | | | | | | | | | GD18/115 | GD18-S/115 | | | | | | | |
| Quick disconnect, Micro DC (M12) | NPN Light On | GLV18-8-200/25/102/159 | GLV18-8-200-S/25/102/159 | GLV18-8-450/25/102/159 | GLV18-8-400-S/25/102/159 | GLV18-55/25/102/159 | GLV18-55-S/25/102/159 | GLV18-6/25/102/159 | GLV18-6-S/25/102/159 | GV18/25/102/159 | GV18-S/25/102/159 | | | | | | | |
| | NPN Dark On | GLV18-8-200/59/102/159 | GLV18-8-200-S/59/102/159 | GLV18-8-450/59/102/159 | GLV18-8-400-S/59/102/159 | GLV18-55/59/102/159 | GLV18-55-S/59/102/159 | GLV18-6/59/102/159 | GLV18-6-S/59/102/159 | GV18/59/102/159 | GV18-S/59/102/159 | | | | | | | |
| | PNP Light On/Dark On | GLV18-8-200/73/120 | GLV18-8-200-S/73/120 | GLV18-8-450/73/120 | GLV18-8-400-S/73/120 | GLV18-55/73/120 | GLV18-55-S/73/120 | GLV18-6/73/120 | GLV18-6-S/73/120 | GV18/73/120 | GV18-S/73/120 | | | | | | | |
| | Thru-Beam Transmitter | | | | | | | | | GD18/159 | GD18-S/159 | | | | | | | |
| Light Spot Diameter | ~15 mm at 200 mm range | | ~30 mm at 400 mm range | | ~200 mm at 5.5 m range | | ~160 mm at 4.5 m range | | ~300 mm at 8 m range | | ~250 mm at 6.5 m range | | ~1.3 m at 25 m range | | 650 mm at 17.5 m range | | | |
| Light Beam Angle | 4° | | 4° | | 2° | | 2° | | 3° | | 2° | | | | | | | |
| AC/DC Supply Voltage | | | | | | | | | | | | | | | | | | |
| 2-meter cable, PVC covered, #22 AWG | Thyristor (AC) or NPN (DC) Light On | GLK18-8-200/25/115/161 | GLK18-8-200-S/25/115/161 | GLK18-8-450/25/115/161 | GLK18-8-400-S/25/115/161 | GLK18-55/25/115/161 | GLK18-55-S/25/115/161 | GLK18-6/25/115/161 | GLK18-6-S/25/115/161 | GK18/25/115/161 | GK18-S/25/115/161 | | | | | | | |
| | Thyristor (AC) or NPN (DC) Dark On | GLK18-8-200/59/115/161 | GLK18-8-200-S/59/115/161 | GLK18-8-450/59/115/161 | GLK18-8-400-S/59/115/161 | GLK18-55/59/115/161 | GLK18-55-S/59/115/161 | GLK18-6/59/115/161 | GLK18-6-S/59/115/161 | GK18/59/115/161 | GK18-S/59/115/161 | | | | | | | |
| | Thru-Beam Transmitter | | | | | | | | | GA18/115 | GA18-S/115 | | | | | | | |
| | Quick disconnect, Micro AC (1/2") | Thyristor (AC) or NPN (DC) Light On | GLK18-8-200/25/161/166 | GLK18-8-200-S/25/161/166 | GLK18-8-450/25/161/166 | GLK18-8-400-S/25/161/166 | GLK18-55/25/161/166 | GLK18-55-S/25/161/166 | GLK18-6/25/161/166 | GLK18-6-S/25/161/166 | GK18/25/161/166 | GK18-S/25/161/166 | | | | | | |
| | Thyristor (AC) or NPN (DC) Dark On | GLK18-8-200/59/161/166 | GLK18-8-200-S/59/161/166 | GLK18-8-450/59/161/166 | GLK18-8-400-S/59/161/166 | GLK18-55/59/161/166 | GLK18-55-S/59/161/166 | GLK18-6/59/161/166 | GLK18-6-S/59/161/166 | GK18/59/161/166 | GK18-S/59/161/166 | | | | | | | |
| Thru-Beam Transmitter | | | | | | | | | | GA18/166 | GA18-S/166 | | | | | | | |
| Light Spot Diameter | ~15 mm at 200 mm range | | ~15 mm at 400 mm range | | ~30 mm at 400 mm range | | ~200 mm at 5.5 m range | | ~160 mm at 4.5 m range | | ~300 mm at 8 m range | | ~250 mm at 6.5 m range | | ~1 m at 25 m range | | 650 mm at 17.5 m range | |
| Light Beam Angle | 4° | | 2° | | 4° | | 2° | | 2° | | 3° | | 2° | | | | | |

| Reference Target | Common Specifications | |
|---------------------------------------|--|------------------------|
| | DC | AC/DC |
| Reference Target | Diffuse: 100 x 100 mm white test card (Polarized) Retro-reflective: FE-RR1 reflector Thru-beam: Receiver | |
| Sensitivity Adjustment | Diffuse modes only | Diffuse modes only |
| Load Current | 100 mA max | 200 mA max |
| Voltage Drop | ≤ 1.5 VDC | ≤ 3.5 V AC/DC |
| Short Circuit and Overload Protection | Yes | Yes |
| Reverse Polarity Protection | Yes | Yes |
| Supply Voltage | 10-30 VDC | 20-250 V AC/DC |
| Current Consumption | < 20 mA | < 2.5 mA |
| Response Time | ≤ 1 ms | ≤ 10 ms |
| Switching Frequency | 500 Hz | 50 Hz |
| Light Source | Visible red LED 640 nm | Visible red LED 640 nm |
| Standards | EN 60947-5-2 | EN 60947-5-2 |
| Protection (IEC) | IP67 | IP67 |
| Ambient Light Resistance | ≤ 30,000 lux | ≤ 30,000 lux |
| Temperature Range WORKING | -13 °F to +140 °F | -4 °F to +140 °F |
| Temperature Range STORAGE | -40 °F to +158 °F | -40 °F to +158 °F |
| Housing Material | PC (Polycarbonate) | PC (Polycarbonate) |
| Lens | PMMA | PMMA |
| Approvals | CE, UL | CE |

PRODUCT DIMENSIONS

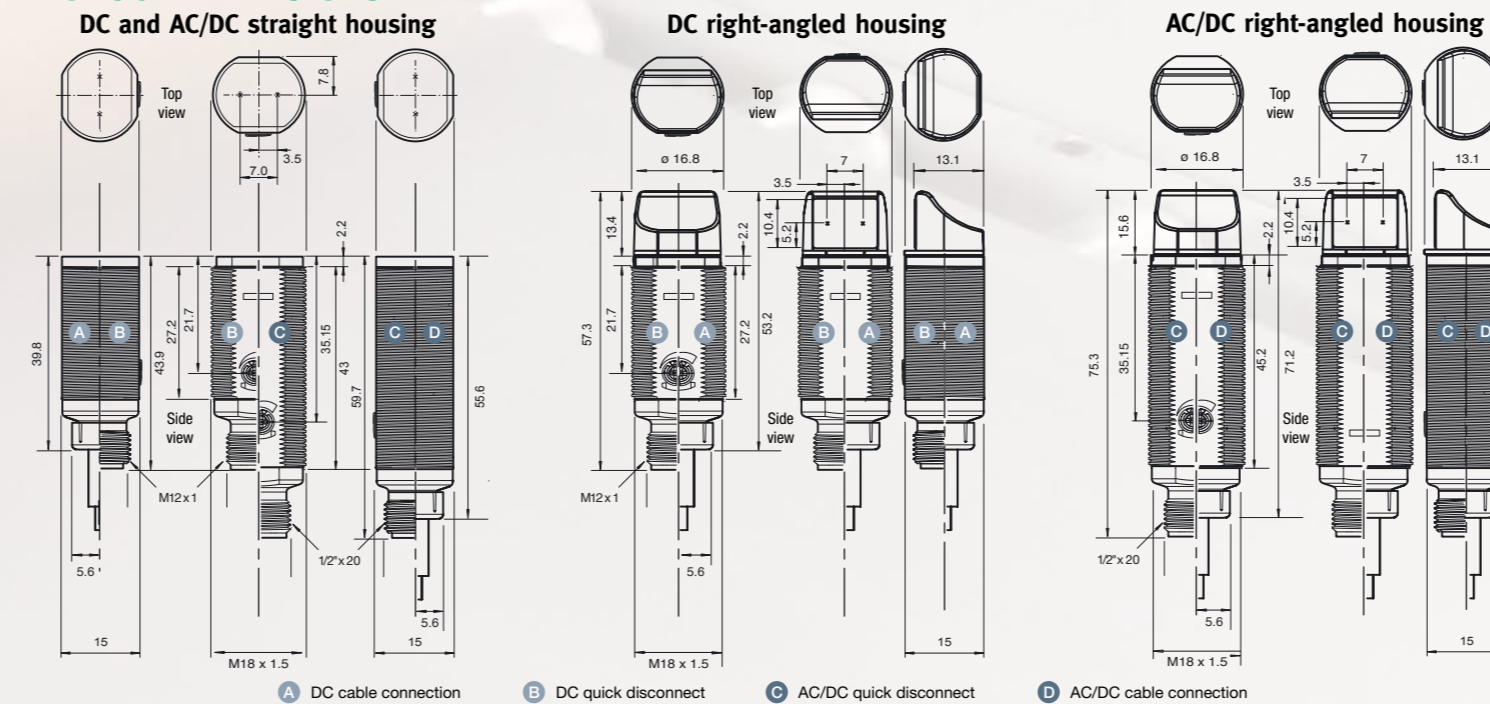

DC ELECTRICAL CONNECTIONS

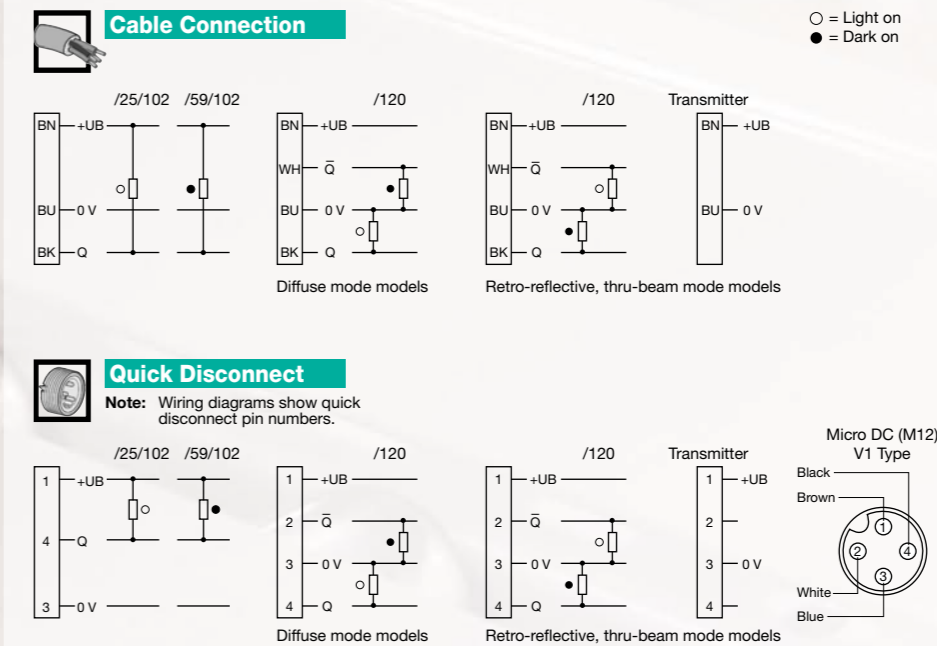

AC/DC ELECTRICAL CONNECTIONS

