

MINAS A6 Series

Additional Technical Information

For Catalogue 4231 Overview – AC Servo Drives & Motion Control (11/2016)

Torque characteristics:

Low inertia 200V AC

Motor type

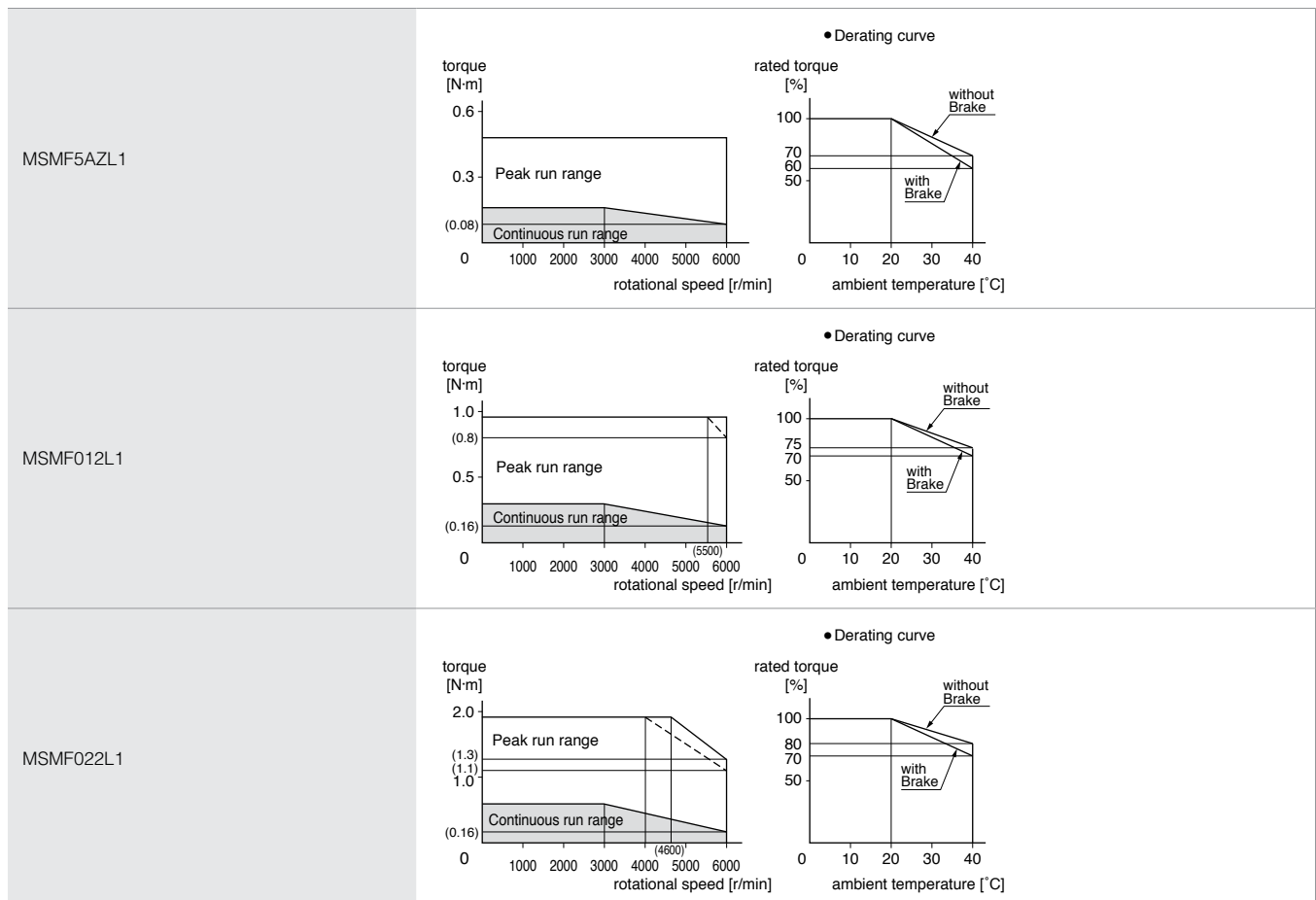

Torque characteristics:

Low inertia 200V AC

Motor type

MSMF042L1	<p>• Derating curve</p> <p>torque [N·m]</p> <p>rated torque [%]</p> <p>Peak run range</p> <p>Continuous run range</p> <p>rotational speed [r/min]</p> <p>ambient temperature [°C]</p>
MSMF082L1	<p>• Derating curve</p> <p>torque [N·m]</p> <p>rated torque [%]</p> <p>Peak run range</p> <p>Continuous run range</p> <p>rotational speed [r/min]</p> <p>ambient temperature [°C]</p>
MSMF092L1	<p>• Derating curve</p> <p>torque [N·m]</p> <p>rated torque [%]</p> <p>Peak run range</p> <p>Continuous run range</p> <p>rotational speed [r/min]</p> <p>ambient temperature [°C]</p>
MSMF102L1	<p>• Derating curve</p> <p>torque [N·m]</p> <p>rated torque [%]</p> <p>Peak run range</p> <p>Continuous run range</p> <p>rotational speed [r/min]</p> <p>ambient temperature [°C]</p>
MSMF152L1	<p>• Derating curve</p> <p>torque [N·m]</p> <p>rated torque [%]</p> <p>Peak run range</p> <p>Continuous run range</p> <p>rotational speed [r/min]</p> <p>ambient temperature [°C]</p>

Torque characteristics:

Medium inertia 200V AC

Motor type

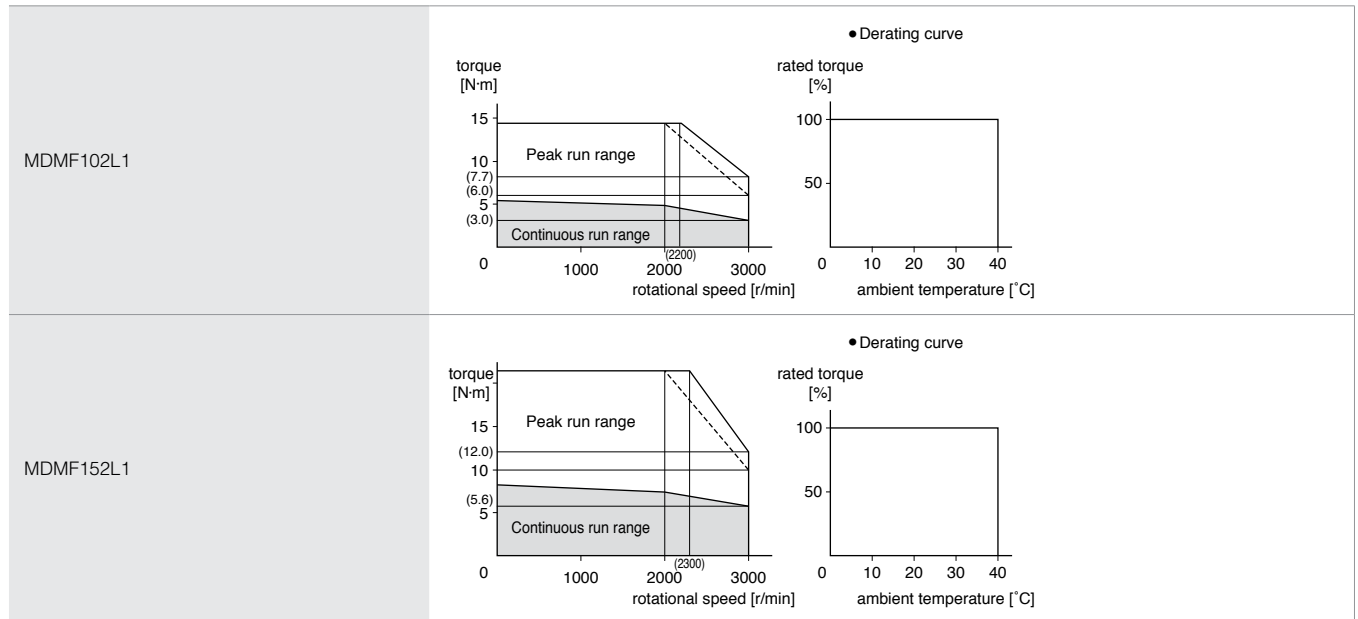

Torque characteristics:

High inertia 200V AC

Motor type

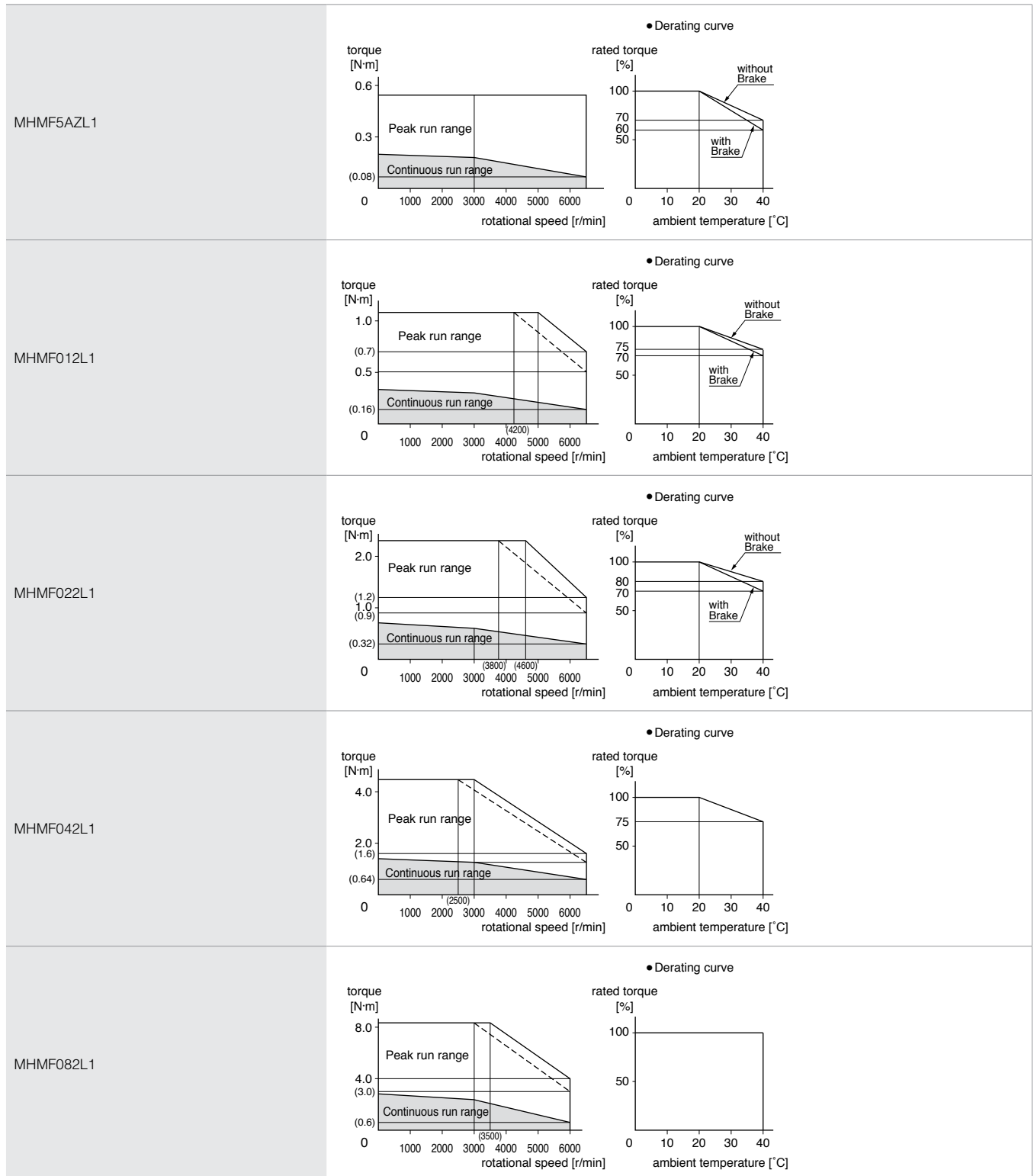

Torque characteristics:

High inertia 200V AC

Motor type

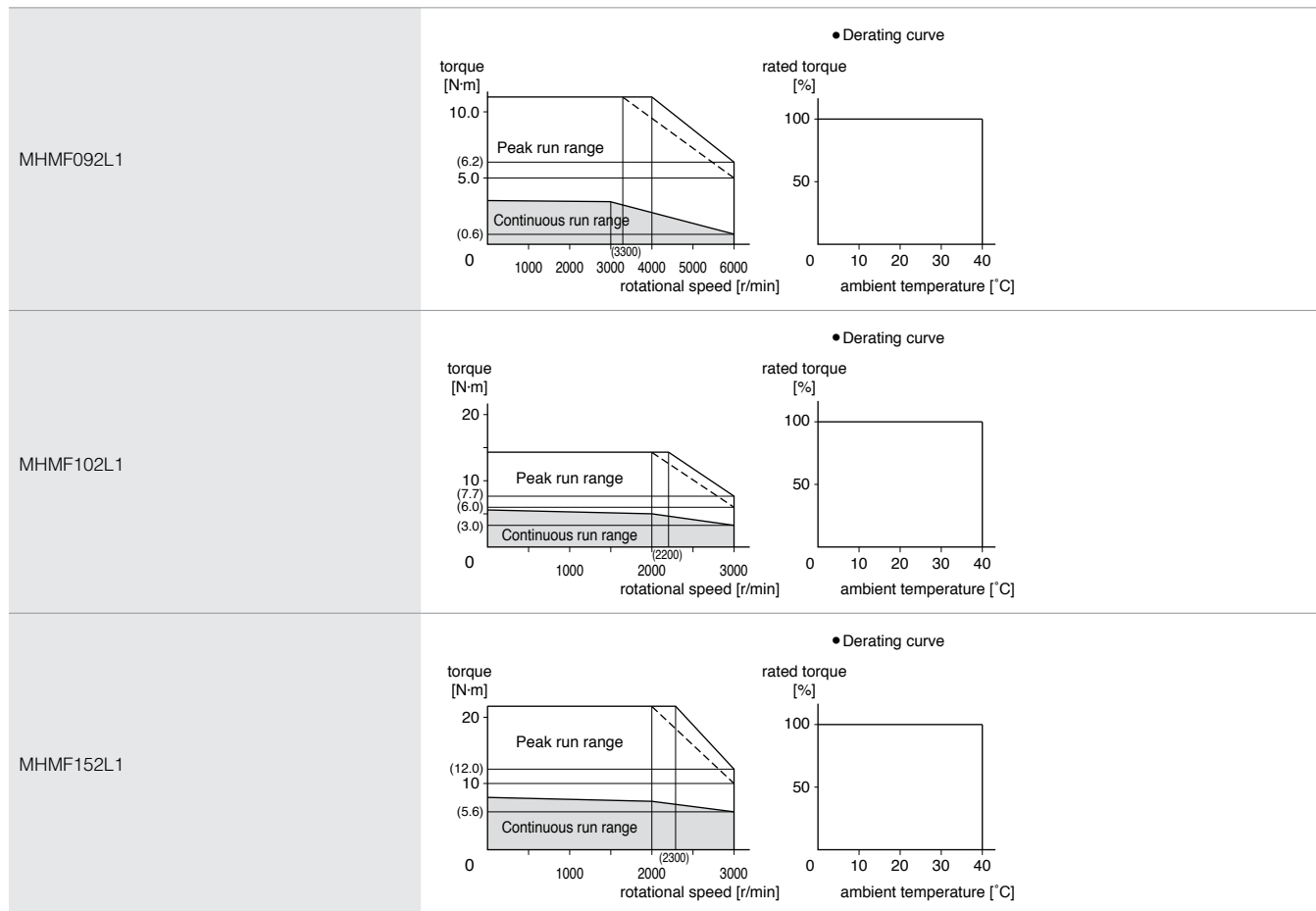

Dimensions MINAS A6 motors

MSMF – Low inertia (50–1500W, 200V AC)

Top view of the motor:

- › The encoder connection is rotated 30° to the axial direction of the motor for MSMF5AZL1 and MSMF012L1□□.
- › The brake connection is rotated 30° to the axial direction of the motor for MSMF5AZL1 and MSMF012L1□□ (only motors with holding brake).

MSMF5AZL1□□.

<without brake>

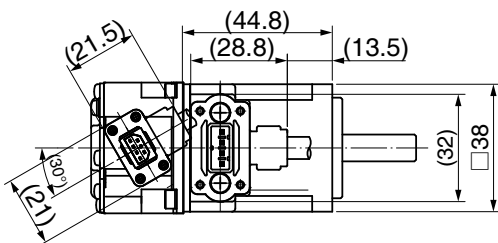

<with brake>

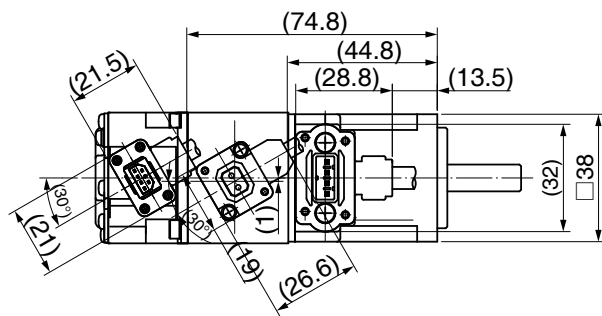

MSMF012L1□□.

<without brake>

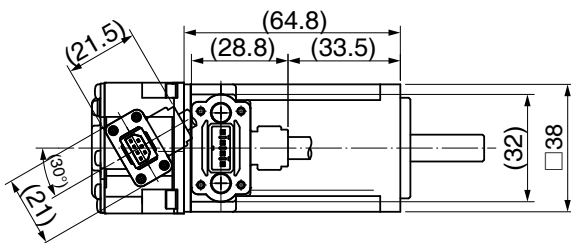

<with brake>

